

Appendix E1-7
LAX SPECIFIC PLAN AMENDMENT STUDY REPORT

Argo Drainage Channel

October 2010

Prepared for:

Los Angeles World Airports
One World Way
Los Angeles, California 90045

Prepared by:

Ricondo & Associates, Inc.
1917 Palomar Oaks Way Suite 350
Carlsbad, CA 92008

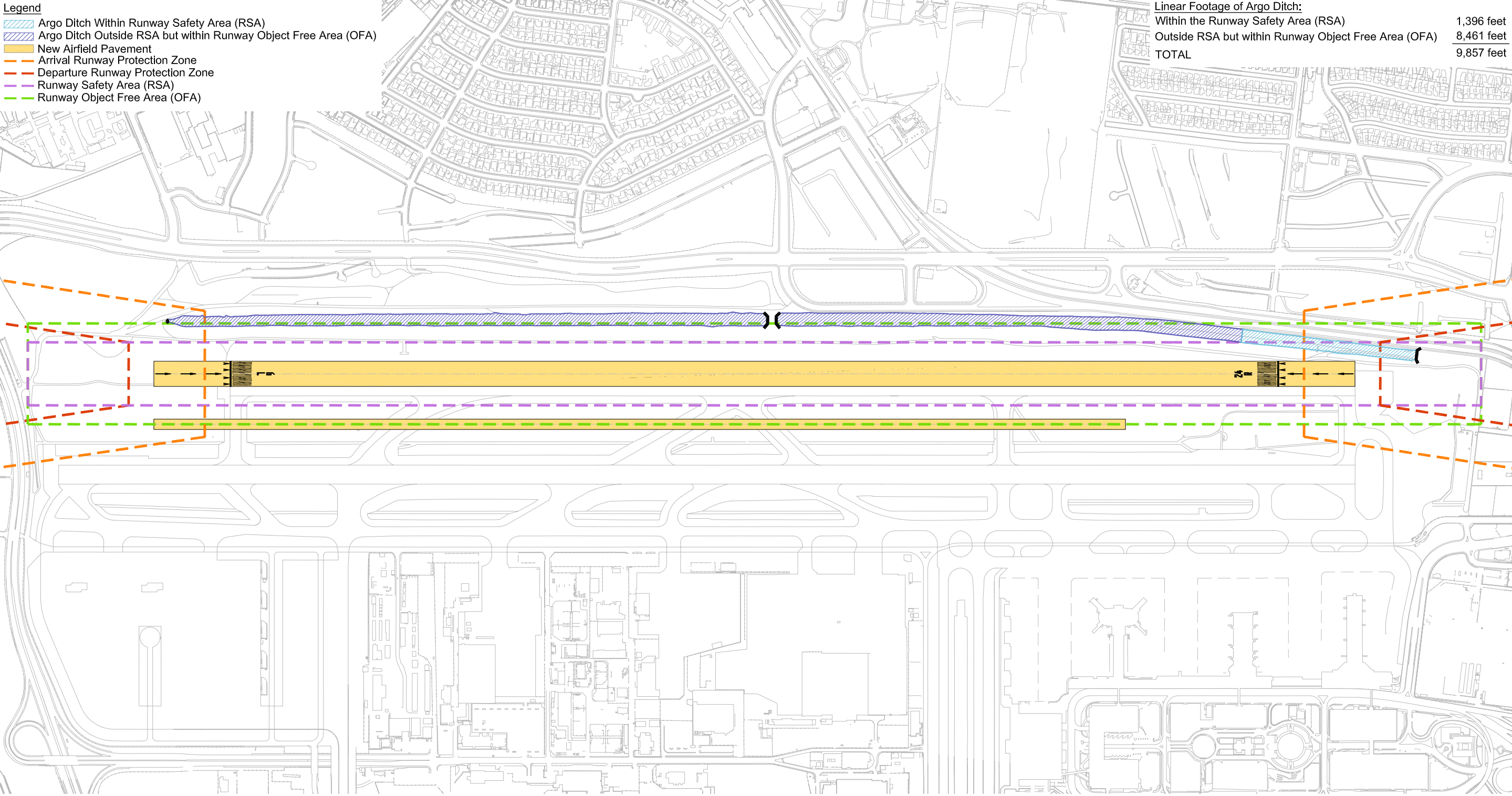

Source: Los Angeles International Airport Layout Plan, 2005; FAA AC 150/5300-13, *Airport Design*; Ricondo & Associates, Inc.
Prepared by: Ricondo & Associates, Inc.

Exhibit 1

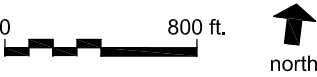

**Linear Footage of Argo Ditch within Runway Improvement Area
Runway 6L-24R Shifted 100 ft. North - Dual Displaced Thresholds**

- Legend
- Argo Ditch Within Runway Safety Area (RSA)
 - Argo Ditch Outside RSA but within Runway Object Free Area (OFA)
 - New Airfield Pavement
 - Arrival Runway Protection Zone
 - Departure Runway Protection Zone
 - Runway Safety Area (RSA)
 - Runway Object Free Area (OFA)

Linear Footage of Argo Ditch:	
Within the Runway Safety Area (RSA)	2,617 feet
Outside RSA but within Runway Object Free Area (OFA)	7,240 feet
TOTAL	9,857 feet

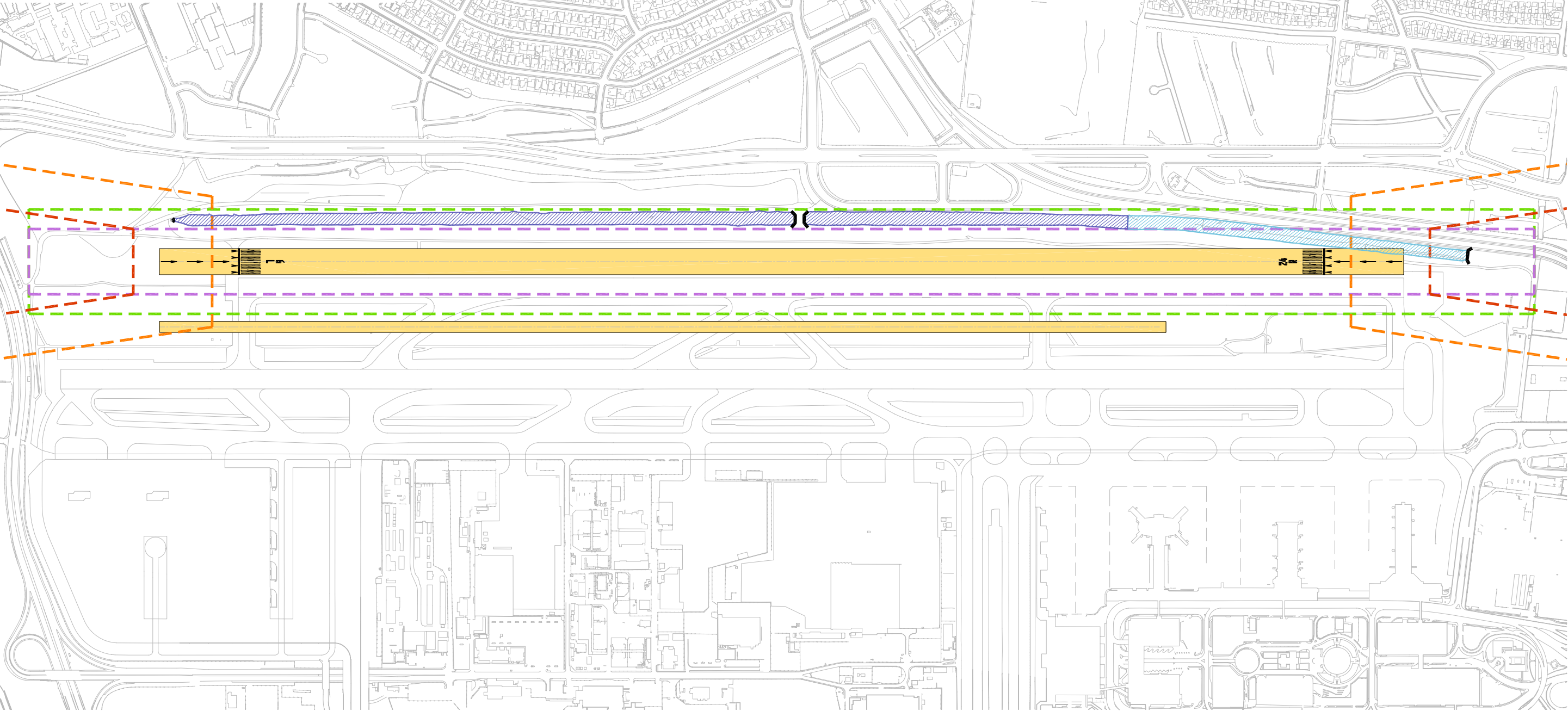

Source: Los Angeles International Airport Layout Plan, 2005; FAA AC 150/5300-13, *Airport Design*; Ricondo & Associates, Inc.
Prepared by: Ricondo & Associates, Inc.

Exhibit 2

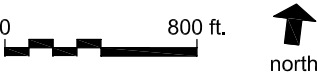

**Linear Footage of Argo Ditch within Runway Improvement Area
Runway 6L-24R Shifted 200 ft. North - Dual Displaced Thresholds**

- Legend
- Argo Ditch Within Runway Safety Area (RSA)
 - New Airfield Pavement
 - Arrival Runway Protection Zone
 - Departure Runway Protection Zone
 - Runway Safety Area (RSA)
 - Runway Object Free Area (OFA)

Linear Footage of Argo Ditch:	
Within the Runway Safety Area (RSA)	9,857 feet
Outside RSA but within Runway Object Free Area (OFA)	0 feet
TOTAL	9,857 feet

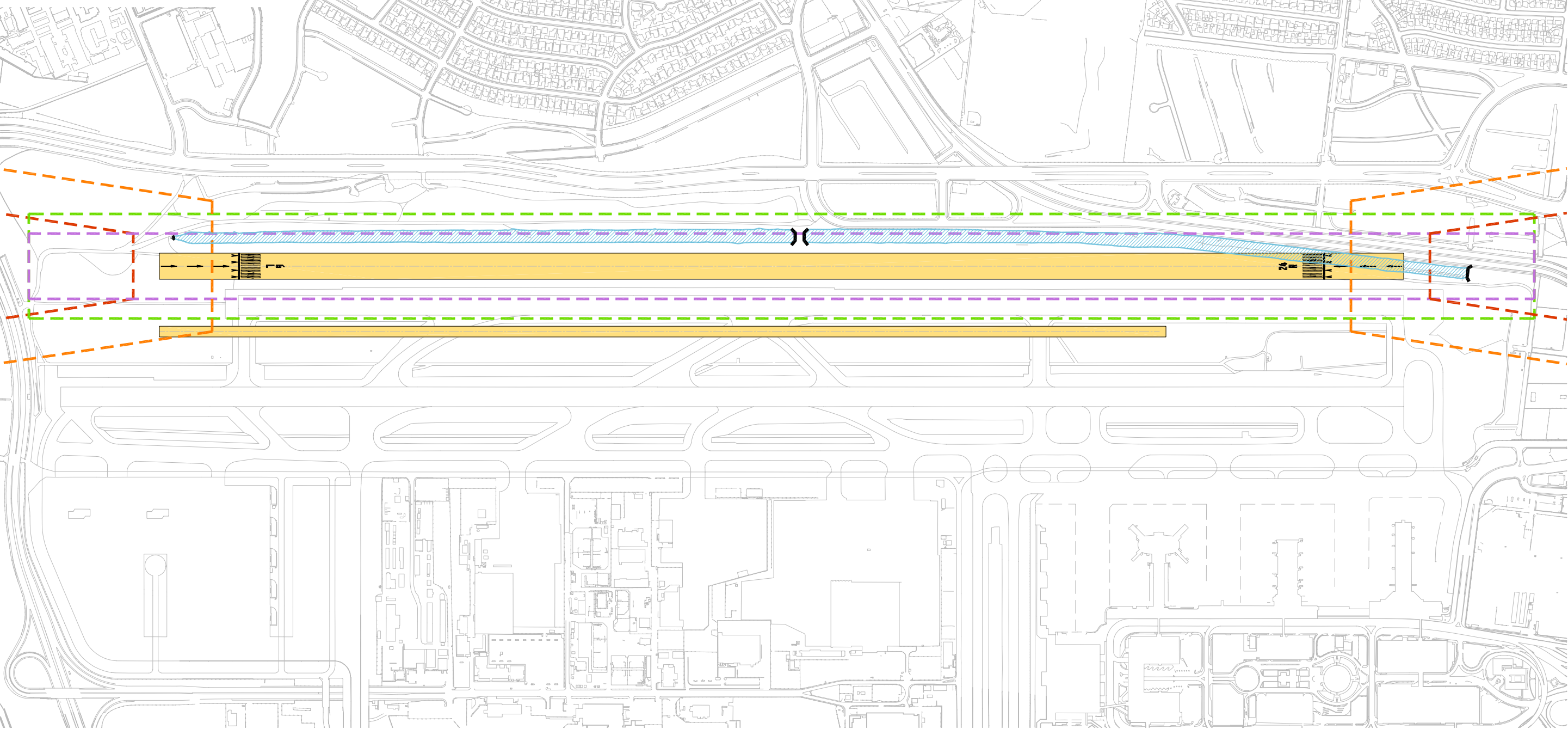

Source: Los Angeles International Airport Layout Plan, 2005; FAA AC 150/5300-13, *Airport Design*; Ricondo & Associates, Inc.
Prepared by: Ricondo & Associates, Inc.

Exhibit 3

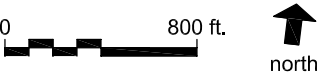

Linear Footage of Argo Ditch within Runway Improvement Area
Runway 6L-24R Shifted 300 ft. North - Dual Displaced Thresholds

- Legend
- Argo Ditch Within Runway Safety Area (RSA)
 - New Airfield Pavement
 - Arrival Runway Protection Zone
 - Departure Runway Protection Zone
 - Runway Safety Area (RSA)
 - Runway Object Free Area (OFA)

Linear Footage of Argo Ditch:	
Within the Runway Safety Area (RSA)	9,857 feet
Outside RSA but within Runway Object Free Area (OFA)	0 feet
TOTAL	9,857 feet

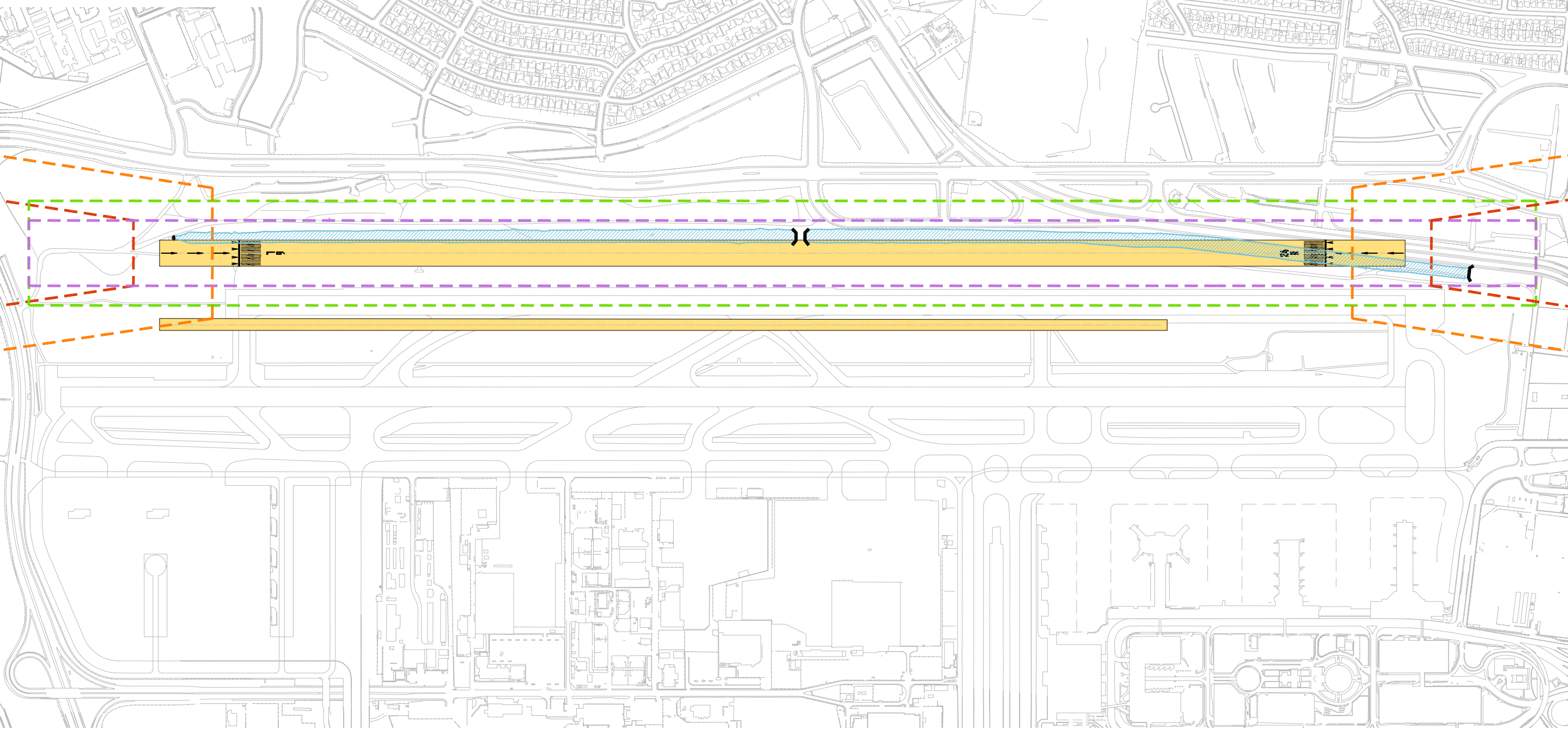

Source: Los Angeles International Airport Layout Plan, 2005; FAA AC 150/5300-13, *Airport Design*; Ricondo & Associates, Inc.
Prepared by: Ricondo & Associates, Inc.

Exhibit 4

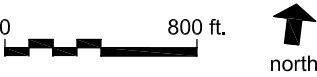

Linear Footage of Argo Ditch within Runway Improvement Area
Runway 6L-24R Shifted 400 ft. North - Dual Displaced Thresholds

