

## Building Information Modeling (BIM)

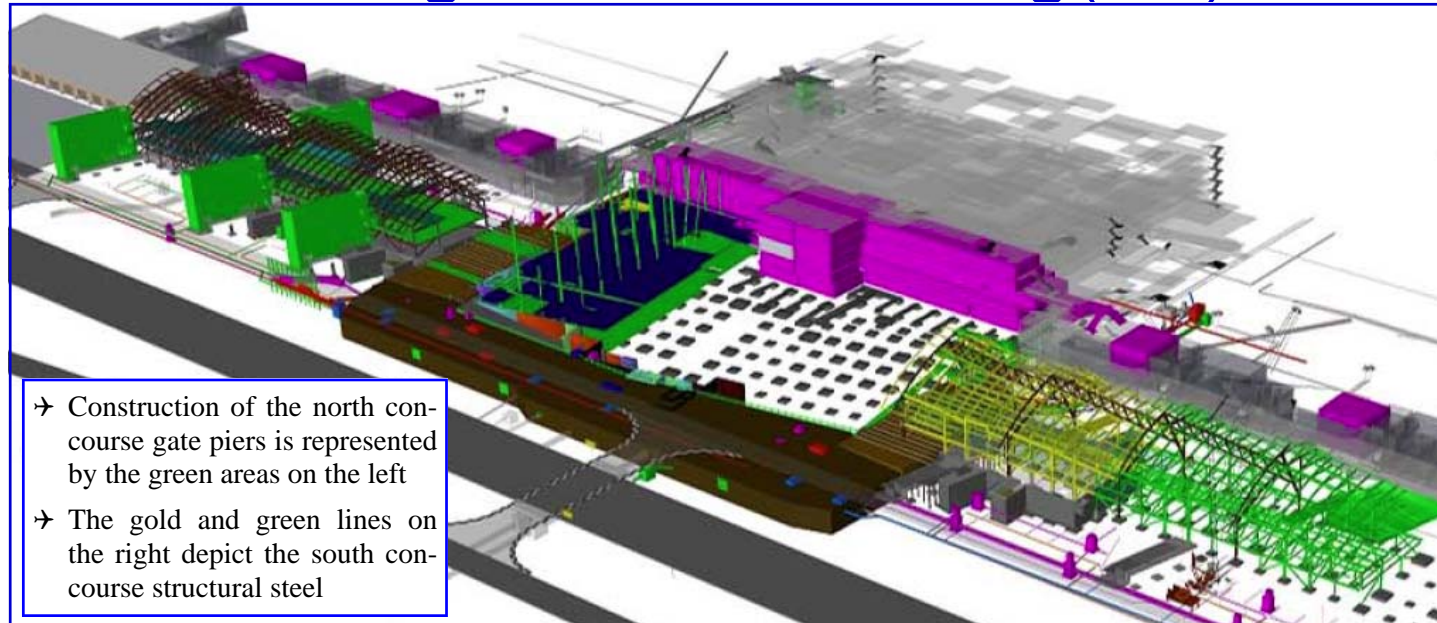

- Construction of the north concourse gate piers is represented by the green areas on the left
- The gold and green lines on the right depict the south concourse structural steel

## Construction Photographs



LAXTEC Corporation  
380 World Way  
Box S - 18  
Los Angeles, CA 90045  
Phone: 310 - 646 - 9378  
Fax: 310 - 646 - 2981  
SITA: VNYLXCR

Published for LAXTEC by:

**AvAirPros**



### Construction Photographs Clockwise From Upper Left

- Core Excavation & Structural Foundation Work
- Core Basement Concrete Walls & Early Steel
- Gate Pier 134 Construction
- North Concourse Level 4 - Departures Level (Looking South)

# TBIT Construction News



## South Concourse Structural Steel

With the majority of the north concourse steel completed, the south concourse steel erection has recently begun and is moving along rapidly as is shown in the below photographs.

The Bradley West construction is now visible from the departures roadway and current TBIT passengers have a front row view from the existing concourses and lounges.

Along with the structural steel, metal decking, masonry block and concrete floor slab pours on the ramp and departure levels are progressing. The new concourses are beginning to take shape, both from the outside perspective as well as from the inside.

Structural steel erection for the new central core area is scheduled to commence in April. This construction will require a crane approximately 100 feet taller than the current crane. Plans for five tower cranes along the length of the project site are in development.

### Inside this issue:

Bradley West  
Program Schedule

2

Building Information  
Modeling

3

Construction  
Photographs

3





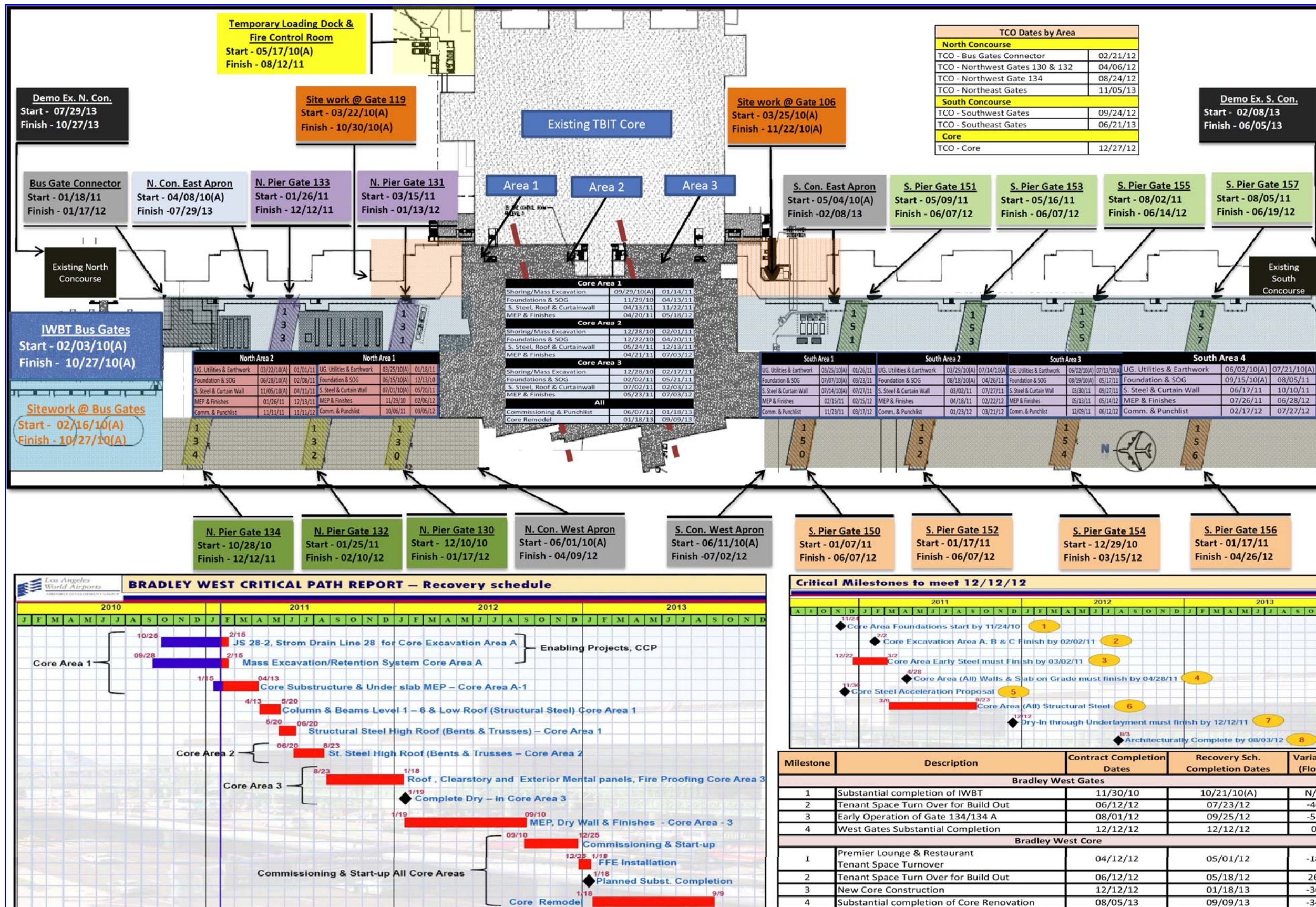

### Bradley West Program Schedule

→ N. Pier Gate 134 Green Box - As depicted in the below photo, the first of the boarding piers for the gates is being constructed. These piers will house stairs, elevators and escalators to facilitate passenger enplaning and deplaning. At ADG VI gates, three passenger loading bridges will be connected to these piers.



→ The photo below shows the Bradley West project site in its entirety and provides a good visual of its proximity to the existing TBIT. The Core will be the location for the new airline premium lounges, restaurants, concessions and shopping mall as well as the greatly expanded CBP operations. Core structural steel erection is scheduled to start in April.

