

# Roadway Impacts Summary



October 2018

## 1. Midfield Satellite Concourse

- a. LADWP Vaults: Work impacting Arrivals Level Outer Lanes #1, #2 and #3 between Terminal 3 and Terminal B, was completed late September.
- b. Jack & Bore: Following the completion of LADWP electrical vault work, crews have moved back to their jack and bore operation curbside to reroute ductbanks between Terminal 3 and Terminal B. This work will occur nightly, Tuesdays through Saturdays, through November 16.

Notice below was issued late September to communicate roadway, pedestrian and ground transportation impacts due to the MSC jack and bore / ductbank work through November 16.

### NIGHTLY (MIDNIGHT TO 8AM)

-  • **RELOCATED:** Lot C / LAX Connection Shuttle Stop between Terminal 3 and Terminal B
  - This shuttle stop will be relocated the northern portion of the FlyAway Shuttle Stop at Terminal B
-  • **CLOSED:** Taxi Zone between Terminal 3 and Terminal B
  - Alternate Taxi Zones located between Terminals 2 & 3 and Terminals B & 4
-  • **RESTRICTED:** Portions of innermost lane and curbside drop-off lane between Terminal 3 and Terminal B
- **CLOSED:** Sidewalk between Terminal 3 and Terminal B
  - ➔ • Detours will be in place to guide pedestrians

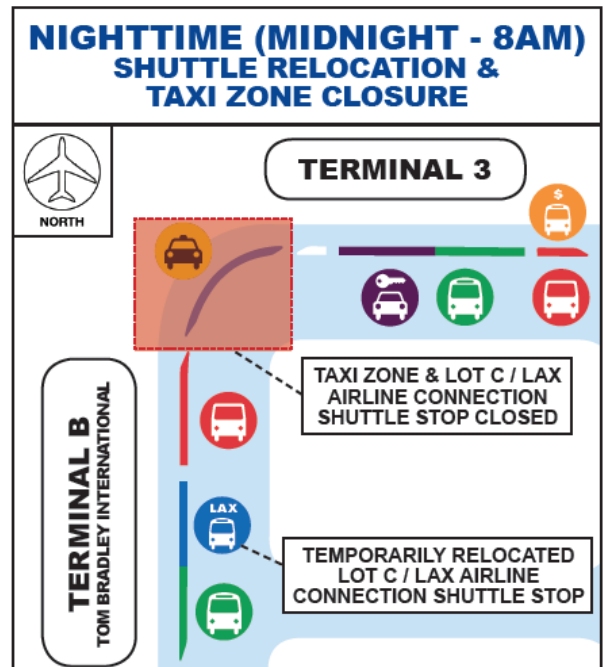
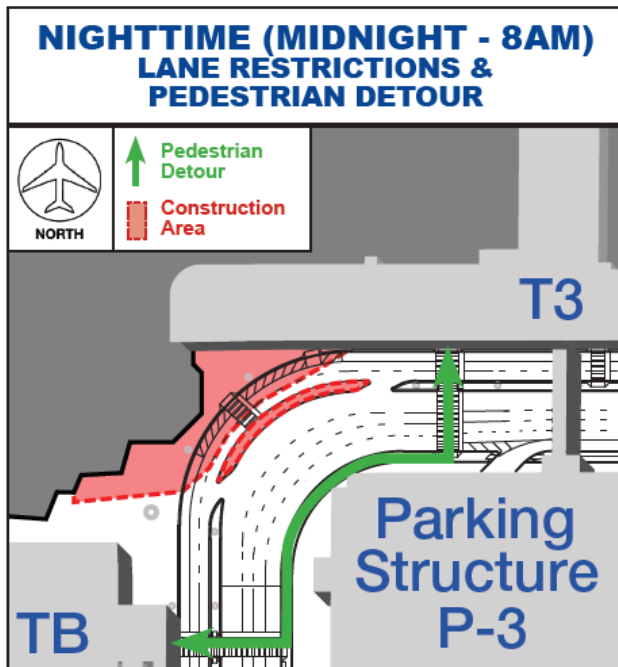

# Roadway Impacts Summary

October 2018

## 2. Delta Canopy Demo

- a. Departures Level – Beginning in October, crews will construct a barricade to allow for the safe demolition of the canopy between Terminal 2 and Terminal 3. This barricade will encompass the sidewalk and adjacent drop-off / pick-up lane at this area. The three lanes of through traffic will not be impacted, but no drop-off's / pick-up's will be allowed at this area. Pedestrians will be rerouted through the terminal buildings.
- b. This barricade will be in place up until the start of the Holiday Moratorium (November 16). Upon completion of the canopy demolition (mid-November), the barricade will move back flush against the terminal building and pedestrian path of travel / vehicular traffic will no longer be impacted.



# Roadway Impacts Summary

October 2018

## 3. Terminal 1.5 Project

- a. Departures Level: Currently, the construction barricade between Terminal 1 and Terminal 2 is not causing any pedestrian or vehicular impacts in the CTA. In January 2019, this barricade will move forward, causing pedestrians to be routed in the drop-off / pick-up lane (protected by a canopy – see below)

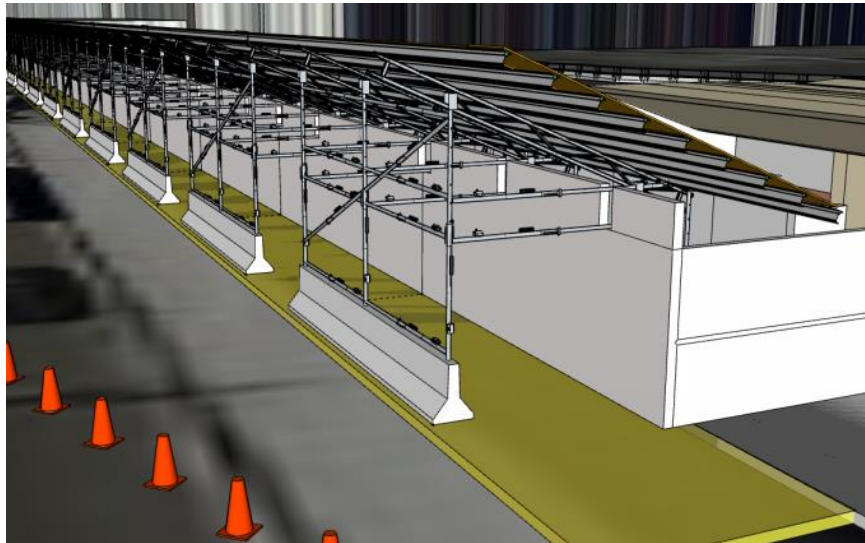

- b. Arrivals Level: Currently, the Terminal 1.5 construction barricade extends to encompass the sidewalk between Terminal 1 and Terminal 2. Pedestrians are being rerouted into the drop-off / pick-up lane (see map below). In late October, this barricade is scheduled to move back, reopening the sidewalk and the drop-off / pick-up lane.

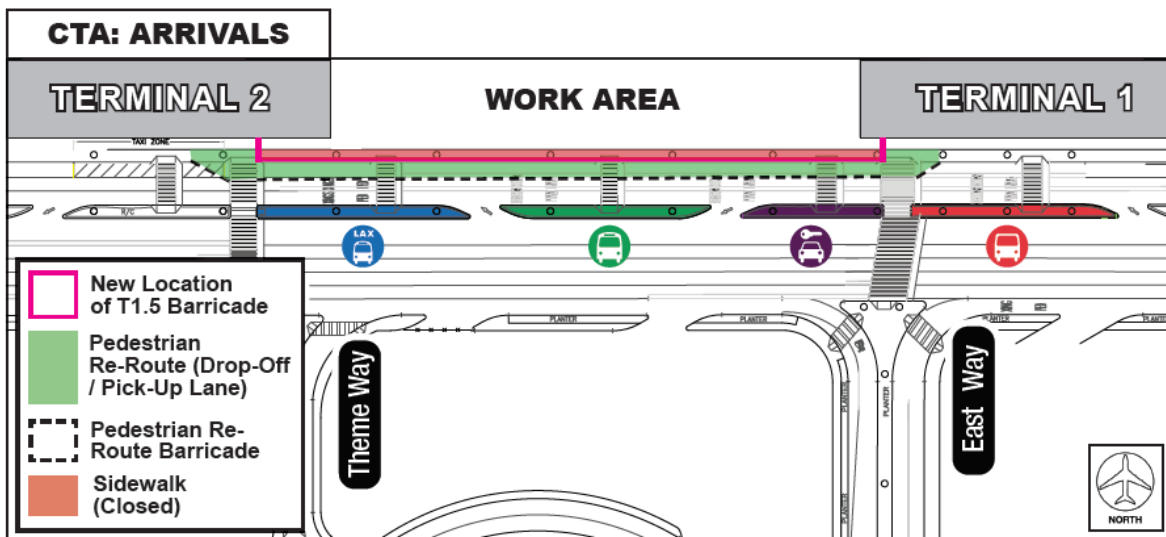

# Roadway Impacts Summary

October 2018

## ONGOING ACTIVITIES

### 4. Automated People Mover

- a. Center Way Nightly Impacts: Portions of Center Way from West Way to Admin East are restricted nightly for APM Early Works including utility surveying, geotechnical borings and potholing.
- b. Center Way Closure / Interim Bus Lot: In September, APM early works closed Center Way between Parking Structure 3 and Parking Structure 4, as well as the east / west ramp leading to and descending from Upper West Way. Neither area will reopen.

Map below was issued in September to highlight the Center Way closure, as well as the location of the Interim Bus Lot (where airline crew and charter busses were relocated to due to the closure of their previous staging area)

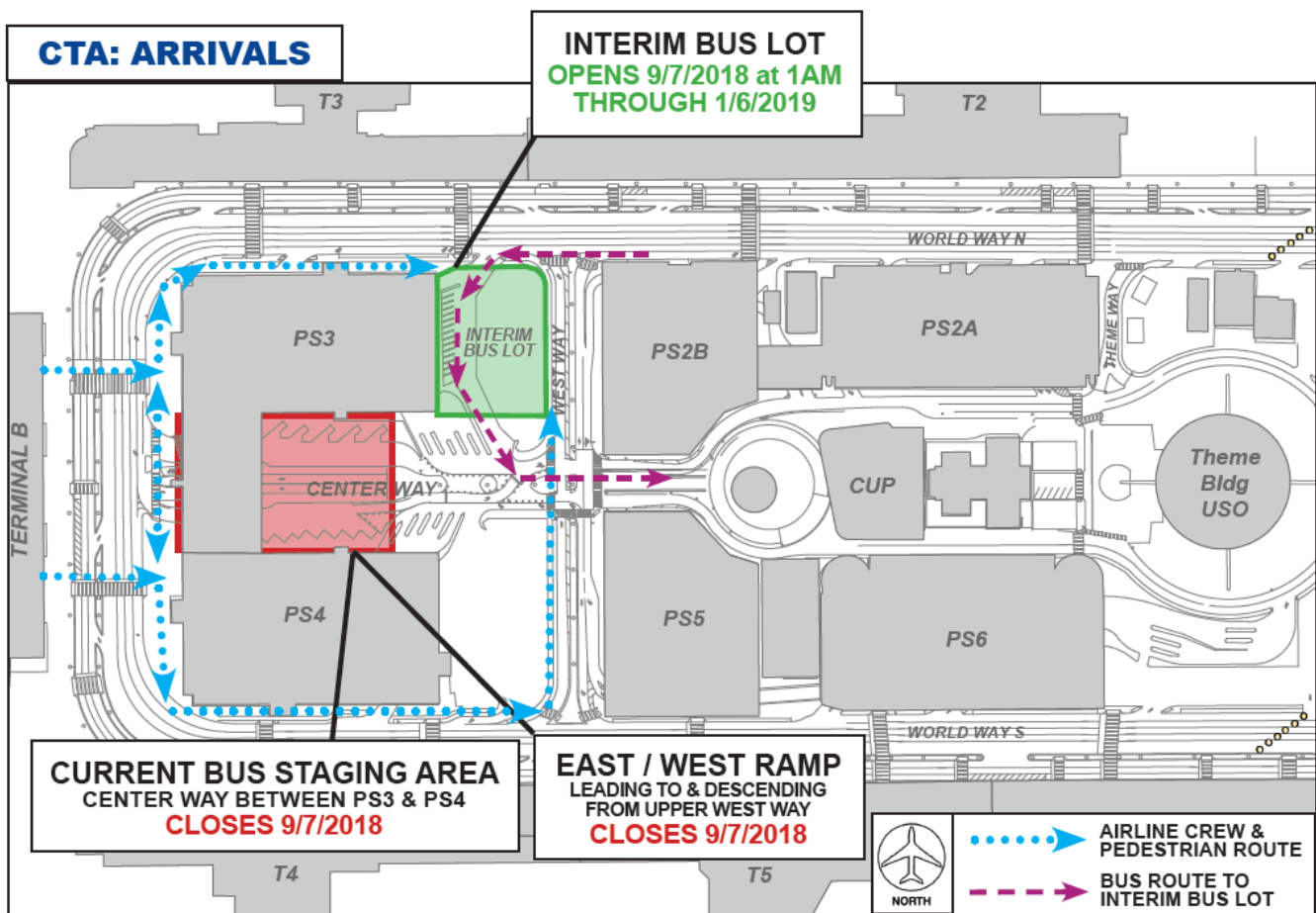

# Roadway Impacts Summary

## October 2018

### 5. CTA Security Bollards

- a. Departures & Arrivals Level Sidewalks: Substantially complete
  - i. Arrivals Level, Terminal 4: Final work zone to be completed early October
- b. Arrivals Level Commercial Curbs: 50% complete
  - i. Expected completion: early November

Map below issued weekly on Thursdays, highlighting work zones for the coming week. Roadway impacts include restrictions of Outer Lane #6 (lane adjacent to commercial curb) nightly from 12AM to 8AM. Respective shuttle stops are closed for the duration of work at each zone, and detours are in place to direct guests to the next available stop.

