

## Join a Training Session

When you were invited to a training session, you received an email with instructions. Just click the link to join the session. Under **Join Session Now**, enter your name and email address, and then click **Join Now**.

You might be asked to enter a session password. You can find this in your training session invitation.

The Webex Training user interface is simple. Training session options in the center and participants and other panels on the right.

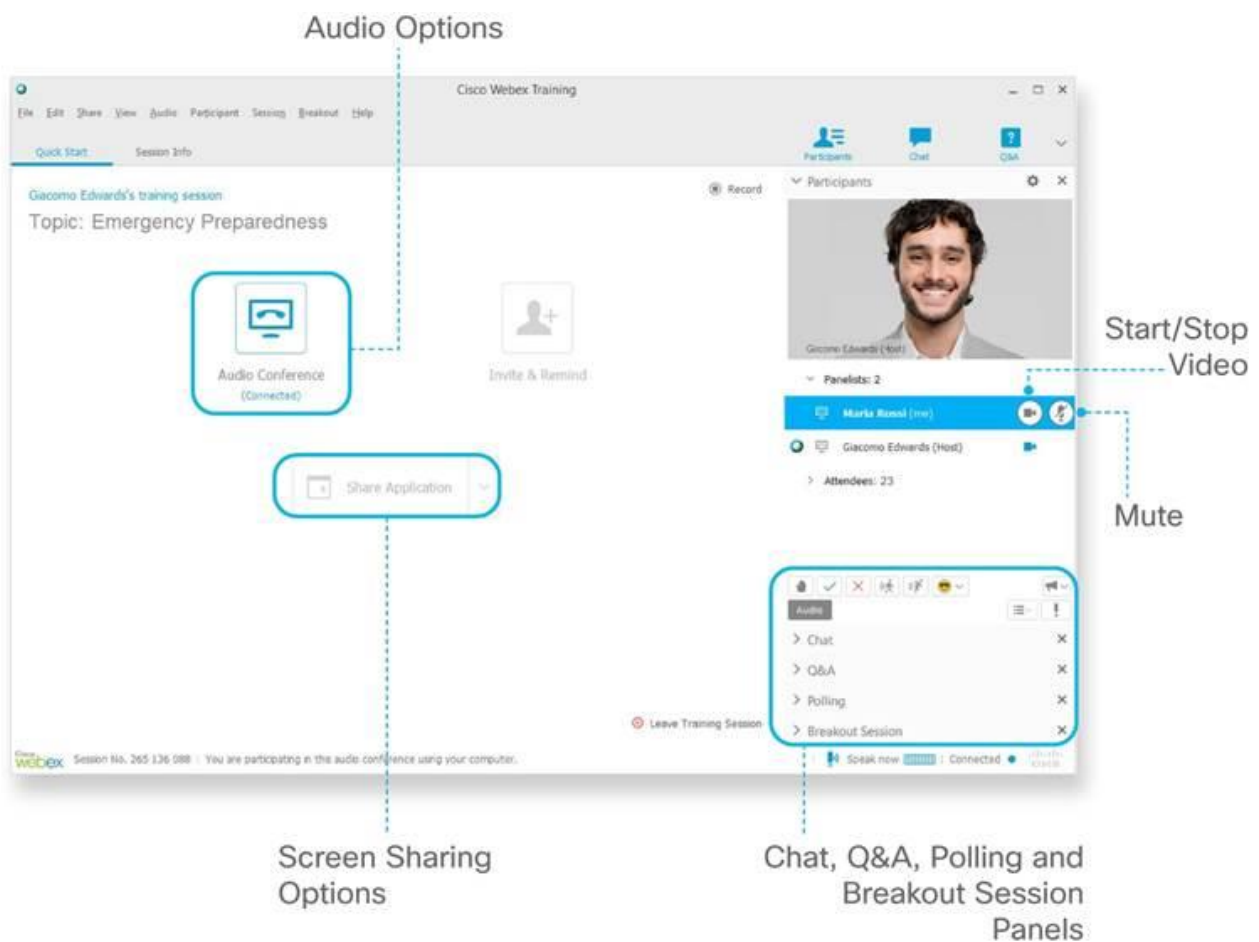

## Connect to Audio

To connect to the audio during a Webex Training session, you can use your phone or your computer (with a headset).



Go to  and select the way you'd like to connect:

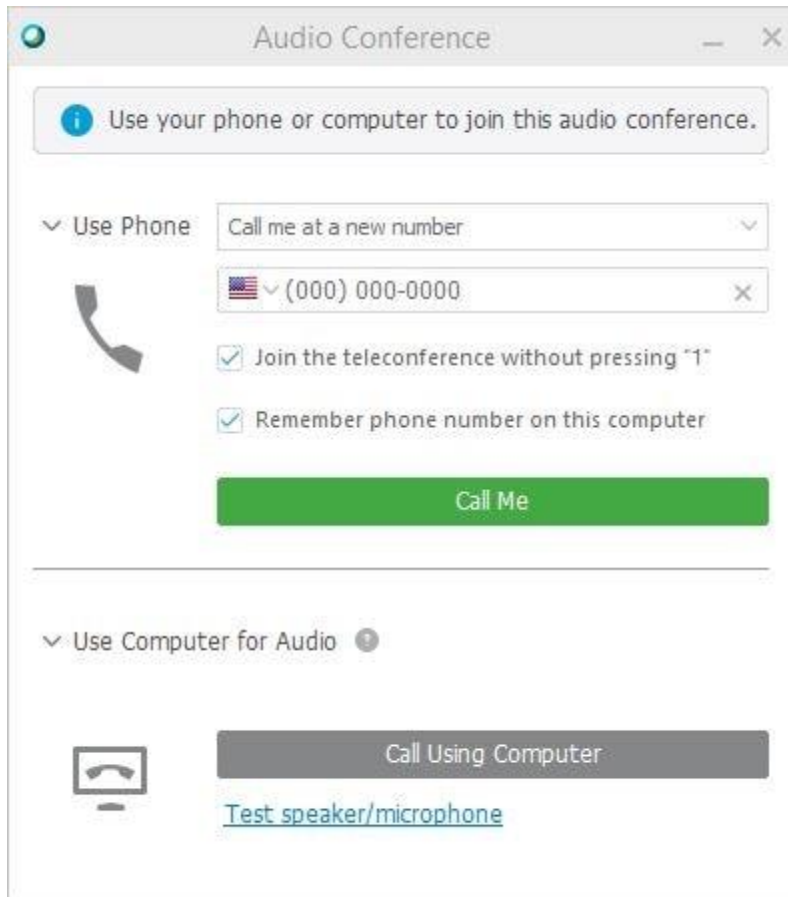

To receive a callback at a different number, select an option from the drop-down list, then select **Call Me**.